

Soft Sealed Butterfly Valve

Product Range

Size	2"-48"
Pressure	150LB/PN10/PN16
Material	WCB, CF8, CF3, CF3M, CF8M Etc.
Seat	PTFE/RUBBER Etc.

Enforced Standard

Design	API 609/ASME B16.34
Face To Face	ANSI B16.10
End Flange	ASME B16.5
Test	API 598

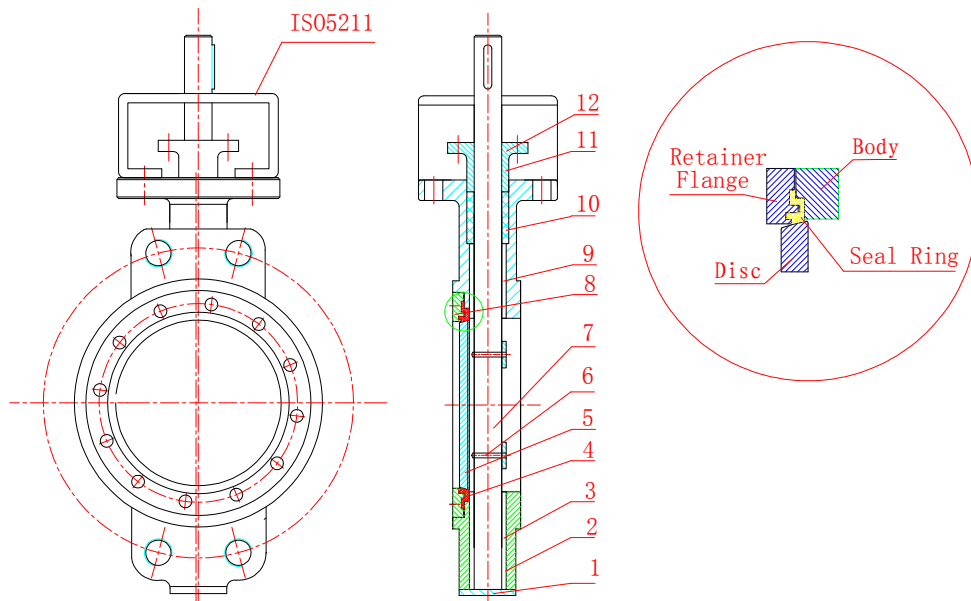

Features:

Long service life, free passage, low resistance coefficient. Suitable for control of water, seawater, sewage, oil, air, vapor, food , medicine, acids, alkalis, salts, paper making etc.

Part Name

No.	1	2	3	4	5	6
Name	Cover	Body	Bushing	Seal Ring	Disc	Pin
No.	7	8	9	10	11	12
Name	Stem	Retainer Flange	Bushing	Packing	Gland	Yoke